

# PATRIOT

## FOODSERVICE EQUIPMENT

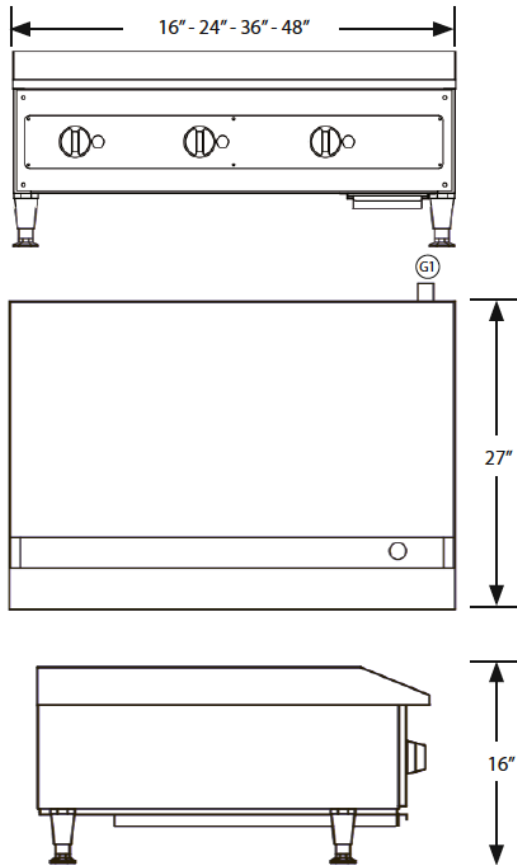

### ESG-15, ESG-24, ESG-36, ESG-48 MEDIUM DUTY GAS GRIDDLES

#### FEATURES

- Stainless and aluminized steel with fully welded construction
- Front access for lighting of pilot lights
- Griddle plate welded seams eliminate grease build up
- 12" wide heating zone per control
- Chrome knobs with visible on/off indicators
- Shipped with natural gas, unit comes with kit for conversion to propane
- Heavy duty 6" legs with height adjustable bullet feet
- Front sliding drip pan tray for easy cleaning
- Polished steel 3/4" thick griddle plate retains heat while cooking
- U-shaped burners allow for steady heat distribution and faster heat recovery
- 2-3/4" Stainless steel sidesplash welded in place
- Includes convertible gas regulator and gas connection
- Cool touch bull-nose front plate protects user from hot surfaces
- Thermostatic controlled griddles maintain user specified heat setting and ensures consistent surface temperature

#### ESG-15 MEDIUM DUTY 16" GAS GRIDDLE

Dimensions (L x W x H)	27" x 16" x 16"
Power ⓘ	3/4" NPT gas connection
BTU	28,000
Shipping Weight	98 lbs

#### ESG-24 MEDIUM DUTY 24" GAS GRIDDLE

Dimensions (L x W x H)	27" x 24" x 16"
Power ⓘ	3/4" NPT gas connection
BTU	56,000
Shipping Weight	170 lbs

#### ESG-36 MEDIUM DUTY 36" GAS GRIDDLE

Dimensions (L x W x H)	27" x 36" x 16"
Power ⓘ	3/4" NPT gas connection
BTU	84,000
Shipping Weight	210 lbs

#### ESG-48 MEDIUM DUTY 48" GAS GRIDDLE

Dimensions (L x W x H)	27" x 48" x 16"
Power ⓘ	3/4" NPT gas connection
BTU	112,000
Shipping Weight	250 lbs

In the pursuit of a better product, durability and performance, PATRIOT reserves the right to change specifications, materials and design without further notice.